

**PA13013** (Variable version)  
**PA12812** (IAM Mechanical version)

Audi/Seat/Skoda/Volkswagen  
OE numbers: 04B121011D / 04B121011DX / 04B121011G



GGT offers two versions of the PA12812 water pump on the market. The mechanical version PA12812, with IAM design in its internal bearing. And the variable version PA13013.

DIFFERENCES  
ABOUT  
DESIGN

1.

PA13013



PA12812



PA13013 has a ring around the impeller, which receives the order from the vehicle's control unit to go up or down, allowing the impeller to run or not the coolant. The mechanical version PA12812 hasn't this ring.

DIFFERENCES  
ABOUT  
DESIGN

2.

PA13013

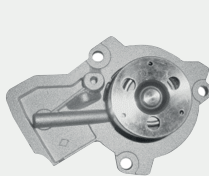

PA12812

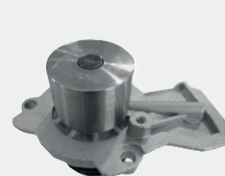

PA13013 has **external bearing**. The mechanical version has a different design incorporating an **internal bearing** (IAM design).

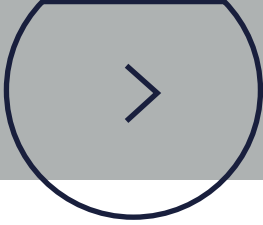

## ASSEMBLY INSTRUCTIONS

### PA12812 ASSEMBLY



Unscrew the electric switch of the original water pump (OE) and screw it into the specific housing as shown in the images