

A254V (OE Variable version)

A254 (IAM Mechanical version)

Audi/Seat/Skoda/Volkswagen

OE numbers: 04B121011D / 04B121011DX / 04B121011G



A254V

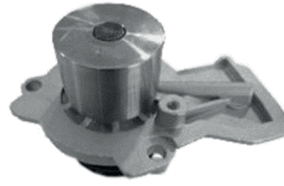

A254

Dolz offers two versions of the A254 water pump on the market. The mechanical version A254, with IAM design in its internal bearing. And the variable version A254V.

**DIFFERENCES
ABOUT
DESIGN**

1.

A254V



A254

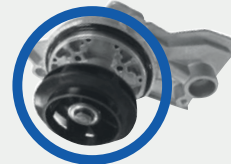

A254V has a ring around the impeller, which receives the order from the vehicle's control unit to go up or down, allowing the impeller to run or not the coolant. The mechanical version A254 hasn't this ring.

**DIFFERENCES
ABOUT
DESIGN**

2.

A254V

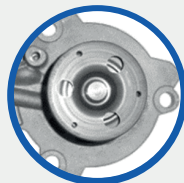
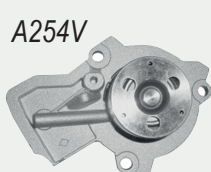

A254

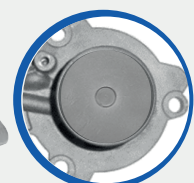

A254V has an **external bearing**. The mechanical version A254 has a different design incorporating an **internal bearing** (IAM design).

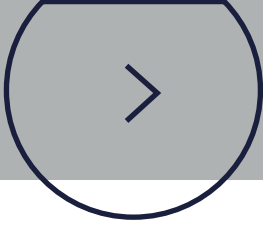

ASSEMBLY INSTRUCTIONS

A254 ASSEMBLY



Unscrew the electric switch of the original water pump (OE) and screw it into the specific housing as shown in the images